

Fresa asimmetrica a finire per macchine bordatrici

Jointing cutter asymmetric for edge-banding machines.



2 PRINCIPI DI TAGLIO

ØD	S	Z	Foro	Codice
100	38	10	30+2CH	AS30.100.38.2.R/L
100	46	12	30+2CH	AS30.100.46.2.R/L
100	53	14	30+2CH	AS30.100.53.2.R/L
100	61	16	30+2CH	AS30.100.61.2.R/L
100	68	18	30+2CH	AS30.100.68.2.R/L

3 PRINCIPI DI TAGLIO

80	68	27	30+2CH	AS30.080.68.3.R/L
100	38	15	30+2CH	AS30.100.38.3.R/L
100	46	18	30+2CH	AS30.100.46.3.R/L
100	53	21	30+2CH	AS30.100.53.3.R/L
100	61	24	30+2CH	AS30.100.61.3.R/L
100	68	27	30+2CH	AS30.100.68.3.R/L
125	38	15	30+2CH	AS30.125.38.3.R/L
125	46	18	30+2CH	AS30.125.46.3.R/L
125	53	21	30+2CH	AS30.125.53.3.R/L
125	61	24	30+2CH	AS30.125.61.3.R/L
125	68	27	30+2CH	AS30.125.68.3.R/L

4 PRINCIPI DI TAGLIO

125	38	20	30+2CH	AS30.125.38.4.R/L
125	46	24	30+2CH	AS30.125.46.4.R/L
125	53	28	30+2CH	AS30.125.53.4.R/L
125	61	32	30+2CH	AS30.125.61.4.R/L
125	68	36	30+2CH	AS30.125.68.4.R/L

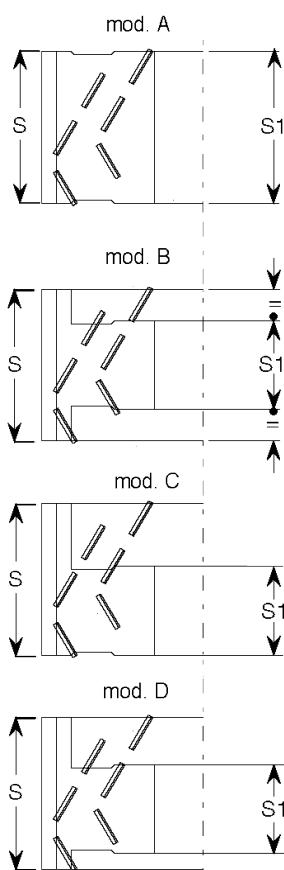

Caratteristiche

Fresa per spianare a spessore costante per macchine bordatrici. Altezza diamante 4 mm.

Characteristics

Cutterhead with constant thickness for edge-banding machines. Diamond height 4 mm.

Fresa asimmetrica a finire per macchine bordatrici

Jointing cutter asymmetric for edge-banding machines.



2 PRINCIPI DI TAGLIO

ØD	S	Z	Foro	Codice
100	38	10	30+2CH	AS31.100.38.2.R/L
100	46	12	30+2CH	AS31.100.46.2.R/L
100	53	14	30+2CH	AS31.100.53.2.R/L
100	61	16	30+2CH	AS31.100.61.2.R/L
100	68	18	30+2CH	AS31.100.68.2.R/L

3 PRINCIPI DI TAGLIO

80	68	27	30+2CH	AS31.080.68.3.R/L
100	38	15	30+2CH	AS31.100.38.3.R/L
100	46	18	30+2CH	AS31.100.46.3.R/L
100	53	21	30+2CH	AS31.100.53.3.R/L
100	61	24	30+2CH	AS31.100.61.3.R/L
100	68	27	30+2CH	AS31.100.68.3.R/L
125	38	15	30+2CH	AS31.125.38.3.R/L
125	46	18	30+2CH	AS31.125.46.3.R/L
125	53	21	30+2CH	AS31.125.53.3.R/L
125	61	24	30+2CH	AS31.125.61.3.R/L
125	68	27	30+2CH	AS31.125.68.3.R/L

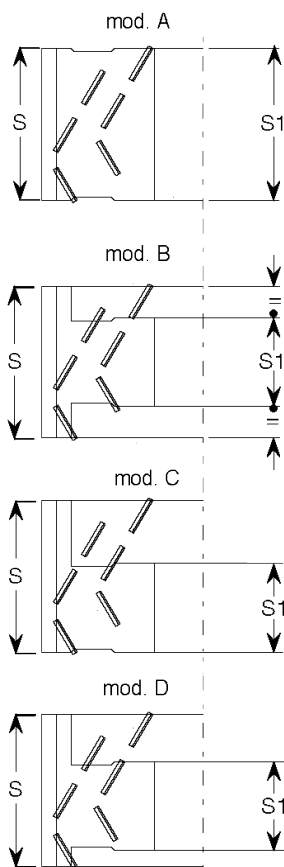

Caratteristiche

Fresa per spianare a spessore costante per macchine bordatrici. Altezza diamante 2.5 mm.

Characteristics

Cutterhead with constant thickness for edge-banding machines. Diamond height 2.5 mm.

Fresa simmetrica a finire per macchine bordatrici

Jointing cutter symmetric for edge-banding machines

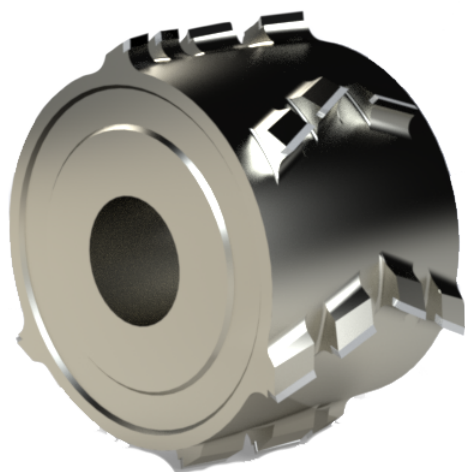

mod. A

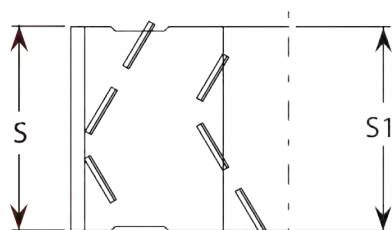

mod.C

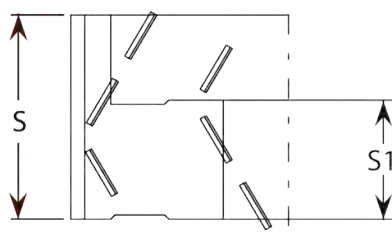

3 PRINCIPI DI TAGLIO

ØD	S	Z	Foro	Codice
80	68	27	30+2CH	AS32.080.68.25
125	38	15	30+2CH	AS32.125.68.25
125	46	18	30+2CH	AS32.125.46.25
125	53	21	30+2CH	AS32.125.53.25
125	61	24	30+2CH	AS32.125.61.25
125	68	27	30+2CH	AS32.125.68.25

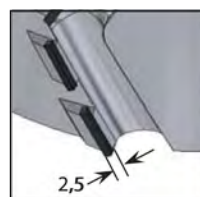

3 PRINCIPI DI TAGLIO

ØD	S	Z	Foro	Codice
80	68	27	30+2CH	AS32.080.68.04
125	38	15	30+2CH	AS32.125.68.04
125	46	18	30+2CH	AS32.125.46.04
125	53	21	30+2CH	AS32.125.53.04
125	61	24	30+2CH	AS32.125.61.04
125	68	27	30+2CH	AS32.125.68.04

**Caratteristiche**

Fresa per spianare a spessore costante per macchine bordatrici.

Characteristics

Cutterhead with constant thickness for edge-banding machines.

Fresa ad inserti a finire per macchine bordatrici

Jointing cutter with knives for edge-banding machines

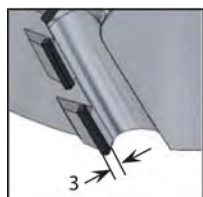
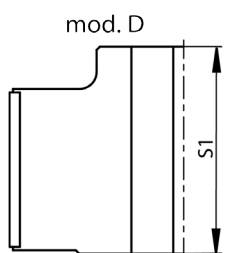
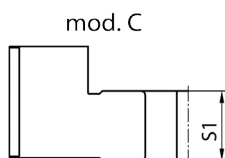
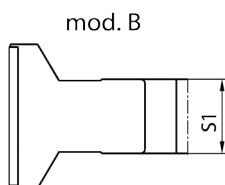
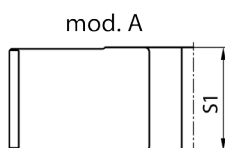

SIMMETRICA

ØD	S	Z	Tipo	Foro	Codice
80	43	3x4	S	30+2CH	AS40.S.080.043
80	65	3x6	S	30+2CH	AS40.S.080.065
100	43	3x4	S	30+2CH	AS40.S.100.043
100	65	3x6	S	30+2CH	AS40.S.100.065
125	43	3x4	S	30+2CH	AS40.S.125.043
125	65	3x6	S	30+2CH	AS40.S.125.065

ASIMMETRICA

100	43	2x4	AS	20+2CH	AS40.A.100.043.2.R/L
100	54	2x5	AS	30+2CH	AS40.A.100.054.2.R/L
100	65	2x6	AS	30+2CH	AS40.A.100.065.2.R/L
85	43	3x4	AS	30+2CH	AS40.A.085.043.3.R/L
100	32	3x3	AS	30+2CH	AS40.A.100.032.3.R/L
100	43	3x4	AS	30+2CH	AS40.A.100.043.3.R/L
100	54	3x5	AS	30+2CH	AS40.A.100.054.3.R/L
100	65	3x6	AS	30+2CH	AS40.A.100.065.3.R/L
100	85	3x8	AS	30+2CH	AS40.A.100.085.3.R/L
100	105	3x10	AS	30+2CH	AS40.A.100.105.3.R/L
125	32	3x3	AS	30+2CH	AS40.A.125.032.3.R/L
125	43	3x4	AS	30+2CH	AS40.A.125.043.3.R/L
125	54	3x5	AS	30+2CH	AS40.A.125.054.3.R/L
125	65	3x6	AS	30+2CH	AS40.A.125.065.3.R/L
125	85	3x8	AS	30+2CH	AS40.A.125.085.3.R/L
125	105	3x10	AS	30+2CH	AS40.A.125.105.3.R/L

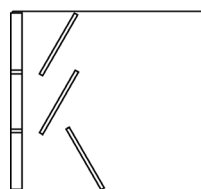

Tipo AS = asimmetrico
Type AS = asymmetric

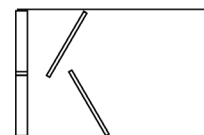

Tipo S = simmetrico
Type S = symmetric

Caratteristiche

Fresa per spianare a spessore costante per macchine bordatrici. Altezza diamante 3 mm.

Characteristics

Cutterhead with constant thickness for edge-banding machines. Diamond height 3 mm.

Fresa a finire per macchine bordatrici (45° assiali)

Jointing cutter asymmetric for edge-banding machines. (45° axial)



3 PRINCIPI DI TAGLIO

ØD	S	Z	Foro	Codice
80	68	27	30+2CH	AS45.080.68.3.R/L
100	38	15	30+2CH	AS45.100.38.3.R/L
100	46	18	30+2CH	AS45.100.46.3.R/L
100	53	21	30+2CH	AS45.100.53.3.R/L
100	61	24	30+2CH	AS45.100.61.3.R/L
100	68	27	30+2CH	AS45.100.68.3.R/L
125	38	15	30+2CH	AS45.125.38.3.R/L
125	46	18	30+2CH	AS45.125.46.3.R/L
125	53	21	30+2CH	AS45.125.53.3.R/L
125	61	24	30+2CH	AS45.125.61.3.R/L
125	68	27	30+2CH	AS45.125.68.3.R/L

4 PRINCIPI DI TAGLIO

125	38	20	30+2CH	AS45.125.38.4.R/L
125	46	24	30+2CH	AS45.125.46.4.R/L
125	53	28	30+2CH	AS45.125.53.4.R/L
125	61	32	30+2CH	AS45.125.61.4.R/L
125	68	36	30+2CH	AS45.125.68.4.R/L

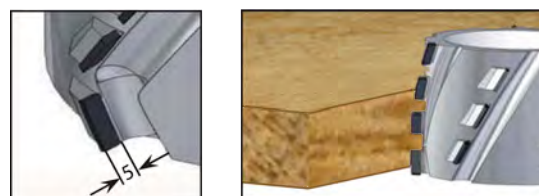
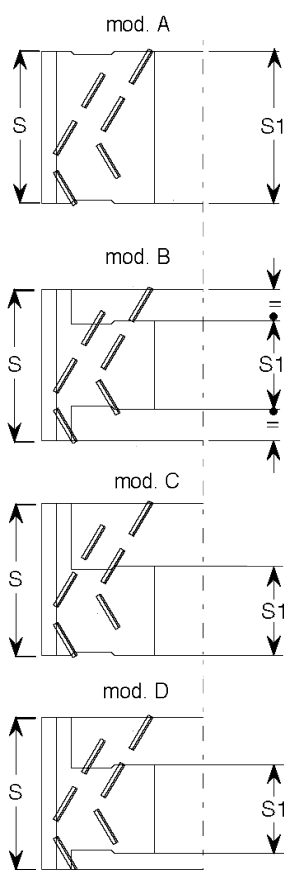

Caratteristiche

Fresa in diamante riaffilabile con assialità 45°, adatta per lavorazioni di pannelli truciolari, M.D.F. con rivestimenti di lamine o carte molto sottili, pannelli multistrati, legno massello.

Altezza diamante 5 mm

Characteristics

Re-sharpening cutter in diamond, cutting angle 45°. Suitable to work on chipboard, M.D.F., covered by thin foils or paper, plywood, solid wood.

Diamond height 5 mm.

Fresa a finire registrabile per squadratrici

Adjustable jointing cutter for double end tenoners machine



DIA=5 mm

ØD	S	Z	Foro	Codice
200	26÷38	12+12	35+2CH	AS10.38.35.05
200	34÷46	12+18	35+2CH	AS10.46.35.05
200	44÷56	12+24	35+2CH	AS10.56.35.05
200	26÷38	12+12	40+2CH	AS10.38.40.05
200	34÷46	12+18	40+2CH	AS10.46.40.05
200	44÷56	12+24	40+2CH	AS10.56.40.05

DIA=2.5 mm

200	26÷38	12+12	35+2CH	AS10.38.35.25
200	34÷46	12+18	35+2CH	AS10.46.35.25
200	44÷56	12+24	35+2CH	AS10.56.35.25
200	26÷38	12+12	40+2CH	AS10.38.40.25
200	34÷46	12+18	40+2CH	AS10.46.40.25
200	44÷56	12+24	40+2CH	AS10.56.40.25

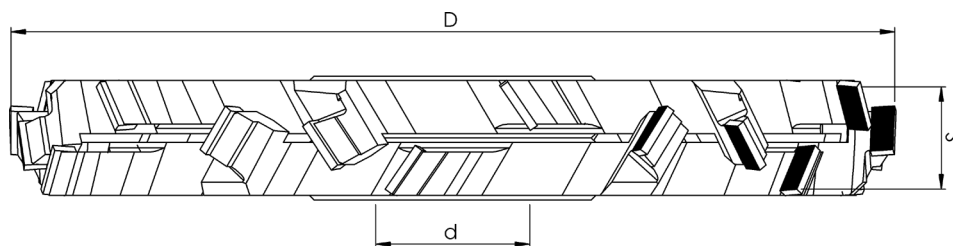

Caratteristiche

Fresa registrabile a finire per macchine squadratrici.

Characteristics

Adjustable jointing cutter for double end tenoners machine.

Fresa a finire per squadratrici e bordatrici (54° assiali)

Jointing cutter for double end tenoners and edge-banding machine (54° axial)



mod. A

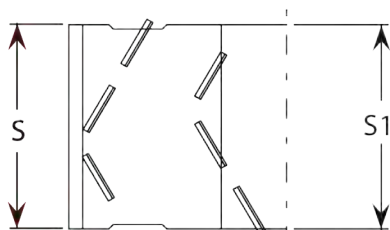

mod. C

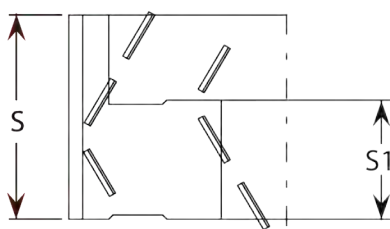

3 PRINCIPI DI TAGLIO

ØD	S	Z	Foro	Codice
100	32	18	30+2CH	AS54.100.32.3.R/L
100	42	24	30+2CH	AS54.100.42.3.R/L
100	52	30	30+2CH	AS54.100.52.3.R/L
100	62	36	30+2CH	AS54.100.62.3.R/L
125	32	18	30+2CH	AS54.125.32.3.R/L
125	42	24	30+2CH	AS54.125.42.3.R/L
125	52	30	30+2CH	AS54.125.52.3.R/L
125	62	36	30+2CH	AS54.125.62.3.R/L

4 PRINCIPI DI TAGLIO

150	32	24	40+2CH	AS54.150.32.4.R/L
150	42	32	40+2CH	AS54.150.42.4.R/L
150	52	40	40+2CH	AS54.150.52.4.R/L
150	62	48	40+2CH	AS54.150.62.4.R/L
180	32	24	40+2CH	AS54.180.32.4.R/L
180	42	32	40+2CH	AS54.180.42.4.R/L
180	52	40	40+2CH	AS54.180.52.4.R/L
180	62	48	40+2CH	AS54.180.62.4.R/L

5 PRINCIPI DI TAGLIO

200	32	30	40+2CH	AS54.200.32.5.R/L
200	42	40	40+2CH	AS54.200.42.5.R/L
200	52	50	40+2CH	AS54.200.52.5.R/L
200	62	60	40+2CH	AS54.200.62.5.R/L

*A RICHIESTA FORNIBILE CON COSTRUZIONE ASIMMETRICA.

*ON REQUEST AVAILABLE WITH ASYMMETRIC CONSTRUCTION.



Caratteristiche

Fresa in diamante riaffilabile con assialità 54°, adatta per lavorazioni di pannelli truciolari, M.D.F. con rivestimenti di lamine o carte molto sottili, pannelli multistrati, legno massello.

Altezza diamante 5 mm

Characteristics

Re-sharpening cutter in diamond, cutting angle 54°. Suitable to work on chipboard, M.D.F., covered by thin foils or paper, plywood, solid wood.

Diamond height 5 mm.

Frese per spigolare per macchine bordatrici

Milling cutters for chamfer on edge-banding machines

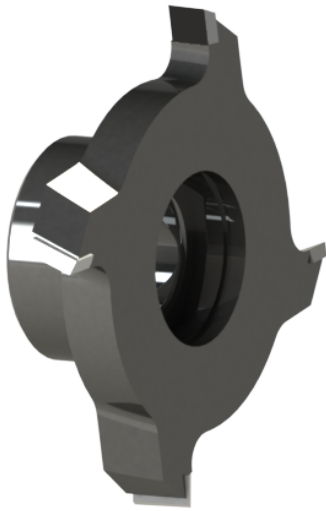

BIESSE

ØD	S	S1	Z	Mod.	Foro	Codice
70	8	22	4	A	20+2CH	FS01.70.8.4.20.R/L
70	8	22	6	A	20+2CH	FS01.70.8.6.20.R/L
80	8	22	4	A	20+2CH	FS01.80.8.4.20.R/L
80	8	22	6	A	20+2CH	FS01.80.8.6.20.R/L

SCM

48	8	12.4	4	A	16+2CH	FS01.48.8.4.16.R/L
----	---	------	---	---	--------	---------------------------

HOMAG e IMA

70	8	22	4	B	HSK25	FS01.70.8.4.25.R/L
70	8	22	6	B	HSK25	FS01.70.8.6.25.R/L
70	8	22	4	A	HSK25	FS01.80.8.4.25.R/L
80	8	22	6	A	HSK25	FS01.80.8.6.25.R/L

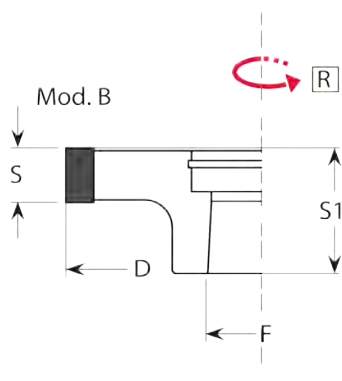
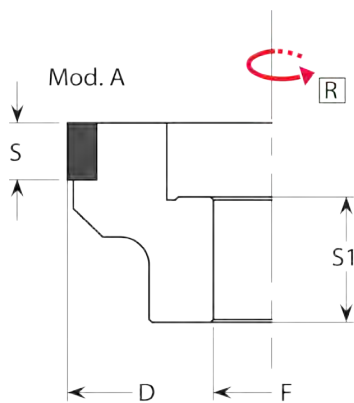

Caratteristiche

Frese per refilare l'eccedenza del laminato plastico su macchine bordatrici. Altezza diamante 2.7mm.

Characteristics

Cutters for draw out the plastic leaf on edge-banding machines. Diamond height 2.7mm.

Frese per spigolare per macchine bordatrici

Milling cutters for chamfer on edge-banding machines



HOMAG

ØD	D1	S1	Z	Mod.	Foro	R	Codice
69	62	17.5	4	A	HSK32	1	FS02.69.04.01.R/L
69	62	17.5	6	A	HSK32	1	FS02.69.06.01.R/L
69	62	17.5	4	A	HSK32	1.5	FS02.69.04.15.R/L
69	62	17.5	6	A	HSK32	1.5	FS02.69.06.15.R/L
70	62	17.5	4	A	HSK32	2	FS02.70.04.02.R/L
70	62	17.5	6	A	HSK32	2	FS02.70.06.02.R/L
70	62	17.5	4	A	HSK32	2.5	FS02.70.04.25.R/L
70	62	17.5	6	A	HSK32	2.5	FS02.70.06.25.R/L
70	62	17.5	4	A	HSK32	3	FS02.70.04.03.R/L
70	62	17.5	6	A	HSK32	3	FS02.70.06.03.R/L
72	62	17.5	4	A	HSK32	4	FS02.72.04.04.R/L
72	62	17.5	6	A	HSK32	4	FS02.72.06.04.R/L
72	62	17.5	4	A	HSK32	5	FS02.72.04.05.R/L
72	62	17.5	6	A	HSK32	5	FS02.72.06.05.R/L
74	62	33	4	B	HSK32	1	FS02.74.04.01.R/L
74	62	33	6	B	HSK32	1	FS02.74.06.01.R/L
74	62	33	4	B	HSK32	1.5	FS02.74.04.15.R/L
74	62	33	6	B	HSK32	1.5	FS02.74.06.15.R/L
74	62	33	4	B	HSK32	2	FS02.74.04.02.R/L
74	62	33	6	B	HSK32	2	FS02.74.06.02.R/L
74	62	33	4	B	HSK32	2.5	FS02.74.04.25.R/L
74	62	33	6	B	HSK32	2.5	FS02.74.06.25.R/L
74	62	33	4	B	HSK32	3	FS02.74.04.03.R/L
74	62	33	6	B	HSK32	3	FS02.74.06.03.R/L
74	62	33	4	B	HSK32	4	FS02.74.04.04.R/L
74	62	33	6	B	HSK32	4	FS02.74.06.04.R/L
74	62	33	4	B	HSK32	5	FS02.74.04.05.R/L
74	62	33	6	B	HSK32	5	FS02.74.06.05.R/L
84	70	23	4	C	HSK25	1	FS02.84.04.01.R/L
84	70	23	6	C	HSK25	1	FS02.84.06.01.R/L
84	70	23	4	C	HSK25	1.5	FS02.84.04.15.R/L
84	70	23	6	C	HSK25	1.5	FS02.84.06.15.R/L
84	70	23	4	C	HSK25	2	FS02.84.04.02.R/L
84	70	23	6	C	HSK25	2	FS02.84.06.02.R/L
84	70	23	4	C	HSK25	2.5	FS02.84.04.25.R/L
84	70	23	6	C	HSK25	2.5	FS02.84.06.25.R/L
84	70	23	4	C	HSK25	3	FS02.84.04.03.R/L
84	70	23	6	C	HSK25	3	FS02.84.06.03.R/L
84	70	23	4	C	HSK25	4	FS02.84.04.04.R/L
84	70	23	6	C	HSK25	4	FS02.84.06.04.R/L
84	70	23	4	C	HSK25	5	FS02.84.04.05.R/L
84	70	23	6	C	HSK25	5	FS02.84.06.05.R/L

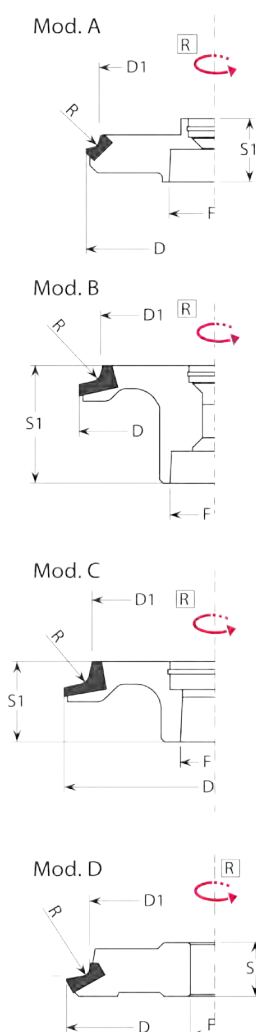

Caratteristiche

Frese per refileare l'eccedenza del laminato plastico su macchine bordatrici. Altezza diamante 3mm.

Characteristics

Cutters for draw out the plastic leaf on edge-banding machines. Diamond height 3mm.

Frese per spigolare per macchine bordatrici

Milling cutters for chamfer on edge-banding machines



SCM

ØD	D1	S1	Z	Mod.	Foro	R	Codice
73	62	12	4	D	12+2CH	1	FS03.73.04.01.R/L
73	62	12	6	D	12+2CH	1	FS03.73.06.01.R/L
73	62	12	4	D	12+2CH	1.5	FS03.73.04.15.R/L
73	62	12	6	D	12+2CH	1.5	FS03.73.06.15.R/L
73	62	12	4	D	12+2CH	2	FS03.73.04.02.R/L
73	62	12	6	D	12+2CH	2	FS03.73.06.02.R/L
73	62	12	4	D	12+2CH	2.5	FS03.73.04.25.R/L
73	62	12	6	D	12+2CH	2.5	FS03.73.06.25.R/L
73	62	12	4	D	12+2CH	3	FS03.73.04.03.R/L
73	62	12	6	D	12+2CH	3	FS03.73.06.03.R/L
73	62	12	4	D	12+2CH	4	FS03.73.04.04.R/L
73	62	12	6	D	12+2CH	4	FS03.73.06.04.R/L
73	62	12	4	D	12+2CH	5	FS03.73.04.05.R/L
73	62	12	6	D	12+2CH	5	FS03.73.06.05.R/L

Mod. A

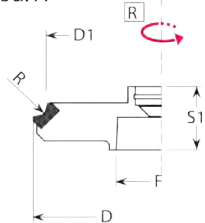

Mod. B

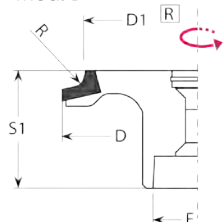

Mod. C

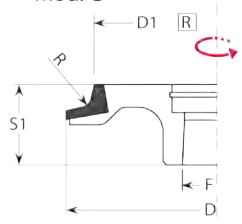

Mod. D

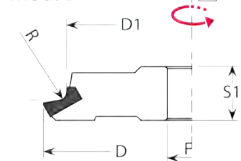

Caratteristiche

Frese per rifilare l'eccedenza del laminato plastico su macchine bordatrici. Altezza diamante 3mm.

Characteristics

Cutters for draw out the plastic leaf on edge-banding machines. Diamond height 3mm.