

Punte tipo ECONOMICO Z3 fora e contorna per pantografo

Drills ECONOMIC type Z3 to perforate and blank for pantograph

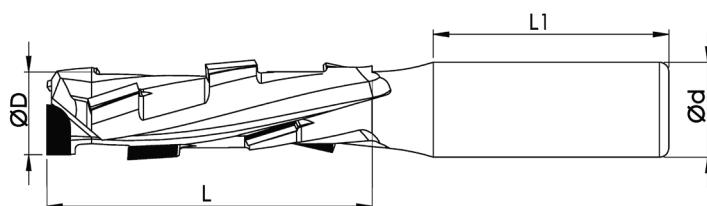

| ØD | L | Ød | L1 | Z | Codice |
|----|----|----|----|--------|--------------------|
| 12 | 27 | 12 | 35 | 3+1HM | FP10.012.27.12.R/L |
| 12 | 27 | 20 | 50 | 3+1HM | FP10.012.27.20.R/L |
| 12 | 27 | 25 | 55 | 3+1HM | FP10.012.27.25.R/L |
| 16 | 27 | 16 | 45 | 3+1HM | FP10.016.27.16.R/L |
| 16 | 27 | 20 | 50 | 3+1HM | FP10.016.27.20.R/L |
| 16 | 27 | 25 | 55 | 3+1HM | FP10.016.27.25.R/L |
| 16 | 35 | 16 | 45 | 4+1HM | FP10.016.35.16.R/L |
| 16 | 35 | 20 | 50 | 4+1HM | FP10.016.35.20.R/L |
| 16 | 35 | 25 | 55 | 4+1HM | FP10.016.35.25.R/L |
| 18 | 27 | 20 | 50 | 3+1HM | FP10.018.27.20.R/L |
| 18 | 27 | 25 | 55 | 3+1HM | FP10.018.27.25.R/L |
| 18 | 35 | 20 | 50 | 4+1HM | FP10.018.35.20.R/L |
| 18 | 35 | 25 | 55 | 4+1HM | FP10.018.35.25.R/L |
| 18 | 43 | 20 | 50 | 5+1HM | FP10.018.43.20.R/L |
| 18 | 43 | 25 | 55 | 5+1HM | FP10.018.43.25.R/L |
| 20 | 27 | 20 | 50 | 3+1HM | FP10.020.27.20.R/L |
| 20 | 27 | 25 | 55 | 3+1HM | FP10.020.27.25.R/L |
| 20 | 35 | 20 | 50 | 4+1HM | FP10.020.35.20.R/L |
| 20 | 35 | 25 | 55 | 4+1HM | FP10.020.35.25.R/L |
| 20 | 43 | 20 | 50 | 5+1HM | FP10.020.43.20.R/L |
| 20 | 43 | 25 | 55 | 5+1HM | FP10.020.43.25.R/L |
| 20 | 52 | 20 | 50 | 6+1HM | FP10.020.52.20.R/L |
| 20 | 52 | 25 | 55 | 6+1HM | FP10.020.52.25.R/L |
| 20 | 60 | 20 | 50 | 7+1HM | FP10.020.60.20.R/L |
| 20 | 68 | 20 | 50 | 8+1HM | FP10.020.68.20.R/L |
| 20 | 76 | 20 | 50 | 9+1HM | FP10.020.76.20.R/L |
| 20 | 84 | 20 | 50 | 10+1HM | FP10.020.87.20.R/L |
| 20 | 90 | 20 | 50 | 11+1HM | FP10.020.90.20.R/L |
| 20 | 98 | 20 | 50 | 12+1HM | FP10.020.98.20.R/L |

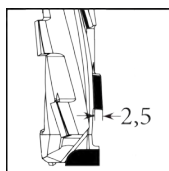

Caratteristiche :

Punta in diamante tipo economico per pantografo, per eseguire: fori, scanalature, battute, sgrossature all'interno dei pannelli. Ottima finitura della parte superiore ed inferiore del pannello grazie all'angolo assiale. Su truciolare rivestito e non, MDF, laminati in genere. Altezza diamante 2.5 mm.

Characteristics:

Diamond drill tipo economico for pantograph, for making: holes, grooves, rough-hewing inside the panels. Excellent finish of the upper and lower part of panel thanks to the axial angle. On coated chipboard and not, MDF, laminated in general. Diamond height 2.5mm.

Punte tipo ECONOMICO Z4 fora e contorna per pantografo

Drills ECONOMIC type Z4 to perforate and blank for pantograph



| ØD | L | Ød | L1 | Z | Codice |
|----|----|----|----|--------|---------------------------|
| 18 | 27 | 20 | 50 | 6+1HM | FP12.018.27.20.R/L |
| 18 | 36 | 20 | 50 | 8+1HM | FP12.018.36.20.R/L |
| 18 | 45 | 20 | 50 | 10+1HM | FP12.018.45.20.R/L |
| 18 | 54 | 20 | 50 | 12+1HM | FP12.018.54.20.R/L |
| 20 | 27 | 20 | 50 | 6+1HM | FP12.020.27.20.R/L |
| 20 | 36 | 20 | 50 | 8+1HM | FP12.020.36.20.R/L |
| 20 | 45 | 20 | 50 | 10+1HM | FP12.020.45.20.R/L |
| 20 | 54 | 20 | 50 | 12+1HM | FP12.020.54.20.R/L |
| 25 | 27 | 25 | 50 | 6+1HM | FP12.025.27.25.R/L |
| 25 | 36 | 25 | 50 | 8+1HM | FP12.025.36.25.R/L |
| 25 | 45 | 25 | 50 | 10+1HM | FP12.025.45.25.R/L |
| 25 | 54 | 25 | 50 | 12+1HM | FP12.025.54.25.R/L |

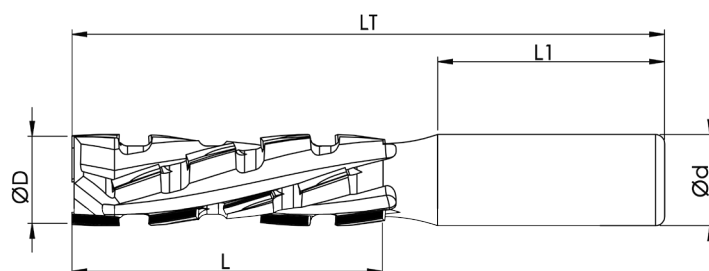
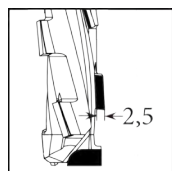

Caratteristiche :

Punta in diamante tipo economico per pantografo, per eseguire: fori, scanalature, battute, sgrossature all'interno dei pannelli. Ottima finitura della parte superiore ed inferiore del pannello grazie all'angolo assiale. Su truciolare rivestito e non, MDF, laminati in genere. Altezza diamante 2.5 mm.

Characteristics:

Diamond drill tipo economico for pantograph, for making: holes, grooves, rough-hewing inside the panels. Excellent finish of the upper and lower part of panel thanks to the axial angle. On coated chipboard and not, MDF, laminated in general. Diamond height 2.5 mm.

Punte fora e contorna Z4 per pantografo

Drills Z4 to perforate and blank for pantograph



| ØD | L | Ød | L1 | Z | Codice |
|----|----|----|----|--------|--------------------|
| 25 | 27 | 20 | 50 | 10+1HM | FP60.025.27.20.R/L |
| 25 | 33 | 20 | 50 | 12+1HM | FP60.025.33.20.R/L |
| 25 | 38 | 20 | 50 | 14+1HM | FP60.025.38.20.R/L |
| 25 | 43 | 20 | 50 | 16+1HM | FP60.025.43.20.R/L |
| 25 | 48 | 20 | 50 | 18+1HM | FP60.025.48.20.R/L |
| 25 | 54 | 20 | 50 | 20+1HM | FP60.025.54.20.R/L |
| 25 | 60 | 20 | 50 | 22+1HM | FP60.025.60.20.R/L |
| 25 | 27 | 25 | 55 | 10+1HM | FP60.025.27.25.R/L |
| 25 | 33 | 25 | 55 | 12+1HM | FP60.025.33.25.R/L |
| 25 | 38 | 25 | 55 | 14+1HM | FP60.025.38.25.R/L |
| 25 | 43 | 25 | 55 | 16+1HM | FP60.025.43.25.R/L |
| 25 | 48 | 25 | 55 | 18+1HM | FP60.025.48.25.R/L |
| 25 | 54 | 25 | 55 | 20+1HM | FP60.025.54.25.R/L |
| 25 | 60 | 25 | 55 | 22+1HM | FP60.025.60.25.R/L |
| 30 | 27 | 20 | 50 | 10+1HM | FP60.030.27.20.R/L |
| 30 | 33 | 20 | 50 | 12+1HM | FP60.030.33.20.R/L |
| 30 | 38 | 20 | 50 | 14+1HM | FP60.030.38.20.R/L |
| 30 | 43 | 20 | 50 | 16+1HM | FP60.030.43.20.R/L |
| 30 | 48 | 20 | 50 | 18+1HM | FP60.030.48.20.R/L |
| 30 | 54 | 20 | 50 | 20+1HM | FP60.030.54.20.R/L |
| 30 | 60 | 20 | 50 | 22+1HM | FP60.030.60.20.R/L |
| 30 | 27 | 25 | 55 | 10+1HM | FP60.030.27.25.R/L |
| 30 | 33 | 25 | 55 | 12+1HM | FP60.030.33.25.R/L |
| 30 | 38 | 25 | 55 | 14+1HM | FP60.030.38.25.R/L |
| 30 | 43 | 25 | 55 | 16+1HM | FP60.030.43.25.R/L |
| 30 | 48 | 25 | 55 | 18+1HM | FP60.030.48.25.R/L |
| 30 | 54 | 25 | 55 | 20+1HM | FP60.030.54.25.R/L |
| 30 | 60 | 25 | 55 | 22+1HM | FP60.030.60.25.R/L |

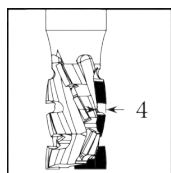
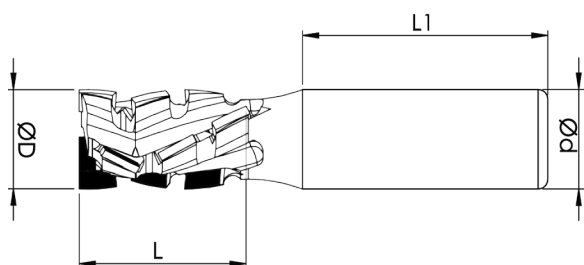

| ØD | L | Ød | L1 | Z | Codice |
|----|----|----|----|--------|--------------------|
| 20 | 27 | 20 | 50 | 10+1HM | FP60.020.27.20.R/L |
| 20 | 33 | 20 | 50 | 12+1HM | FP60.020.33.20.R/L |
| 20 | 38 | 20 | 50 | 14+1HM | FP60.020.38.20.R/L |
| 20 | 43 | 20 | 50 | 16+1HM | FP60.020.43.20.R/L |
| 20 | 48 | 20 | 50 | 18+1HM | FP60.020.48.20.R/L |
| 20 | 54 | 20 | 50 | 20+1HM | FP60.020.54.20.R/L |
| 20 | 60 | 20 | 50 | 22+1HM | FP60.020.60.20.R/L |

Caratteristiche :

Punta in diamante per pantografo, per eseguire: fori, scanalature, battute, sgrossature.

La particolare disposizione delle placchette consente di migliorare l'asportazione e ridurre la rumorosità.

Particolarmente adatta per lavorare ad alte velocità di taglio in fase di contornatura, ottima finitura del pannello. Su truciolare rivestito e non, MDF, laminati in genere. Altezza diamante 4 mm

Characteristics:

Diamond drill for pantograph to realise: holes, grooves, rough-hewing.

The particular position of the cutters reduces the noise and improves the removal of wood. Excellent for works at high speed, on chipboard coated panels and not, MDF, laminated in general. Diamond height 4 mm.

Punte fora e contorna per pantografo (NESTING)

Drills to perforate and blank for pantograph (NESTING)



| ØD | L | Ød | LT | Z | Codice |
|----|----|----|-----|------|--------------------------|
| 10 | 22 | 12 | 75 | 8+1 | FN01.10.22.12.R/L |
| 10 | 28 | 12 | 80 | 10+1 | FN01.10.28.12.R/L |
| 12 | 22 | 12 | 75 | 12+1 | FN01.12.22.12.R/L |
| 12 | 28 | 12 | 80 | 15+1 | FN01.12.28.12.R/L |
| 14 | 22 | 16 | 80 | 12+1 | FN01.14.22.16.R/L |
| 14 | 28 | 16 | 85 | 15+1 | FN01.14.28.16.R/L |
| 16 | 28 | 16 | 85 | 15+1 | FN01.16.28.16.R/L |
| 16 | 34 | 16 | 90 | 18+1 | FN01.16.34.16.R/L |
| 16 | 40 | 16 | 95 | 21+1 | FN01.16.40.16.R/L |
| 16 | 45 | 20 | 100 | 24+1 | FN01.16.45.16.R/L |
| 20 | 28 | 20 | 85 | 15+1 | FN01.20.28.20.R/L |
| 20 | 34 | 20 | 90 | 18+1 | FN01.20.34.20.R/L |
| 20 | 40 | 20 | 95 | 21+1 | FN01.20.40.20.R/L |
| 20 | 45 | 20 | 100 | 24+1 | FN01.20.45.20.R/L |

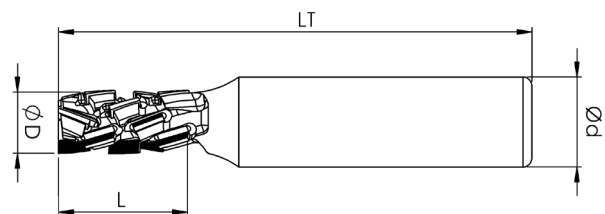

Caratteristiche :

Punte per pantografo studiate per la lavorazione specifica del NESTING, Ideali per pantografatura e fresatura di pannelli in truciolare, MDF e multistrato sia grezzi che rivestiti, da utilizzare su macchine CNC. Ottima finitura sul pannello e sul rivestimento.

Corpo in materiale antivibrante.

Characteristics:

Router studied for Nesting, ideal for milling and contouring chipboards, Mdf, with our without veneer, used on CNC machines. Excellent finishing both on panel and coating.

Vibration resistant body

Punte fora e contorna per pantografo

Drills to perforate and blank for pantograph



| ØD | L | Ød | Z | Codice |
|----|----|----|------|---------------------------|
| 20 | 25 | 20 | 8+1 | FP45.020.25.20.R/L |
| 20 | 30 | 20 | 10+1 | FP45.020.30.20.R/L |
| 20 | 36 | 20 | 12+1 | FP45.020.36.20.R/L |
| 20 | 42 | 20 | 14+1 | FP45.020.42.20.R/L |
| 20 | 47 | 20 | 16+1 | FP45.020.47.20.R/L |
| 20 | 53 | 20 | 18+1 | FP45.020.53.20.R/L |
| 22 | 25 | 20 | 8+1 | FP45.022.25.20.R/L |
| 22 | 30 | 20 | 10+1 | FP45.022.30.20.R/L |
| 22 | 36 | 20 | 12+1 | FP45.022.36.20.R/L |
| 22 | 42 | 20 | 14+1 | FP45.022.42.20.R/L |
| 22 | 47 | 20 | 16+1 | FP45.022.47.20.R/L |
| 22 | 53 | 20 | 18+1 | FP45.022.53.20.R/L |
| 25 | 25 | 25 | 8+1 | FP45.025.25.25.R/L |
| 25 | 30 | 25 | 10+1 | FP45.025.30.25.R/L |
| 25 | 36 | 25 | 12+1 | FP45.025.36.25.R/L |
| 25 | 42 | 25 | 14+1 | FP45.025.42.25.R/L |
| 25 | 47 | 25 | 16+1 | FP45.025.47.25.R/L |
| 25 | 53 | 25 | 18+1 | FP45.025.53.25.R/L |

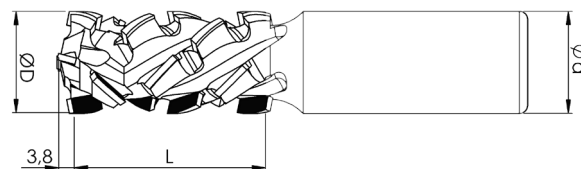

Caratteristiche :

Punta in diamante taglio assiale 45°, adatta per lavorazioni di pannelli truciolari, M.D.F. con rivestimenti di lamine o carte molto sottili, elevate velocità di avanzamento, eccellente finitura ed estrazione del truciolo grazie alla speciale geometria di costruzione, bassa rumorosità.

Altezza diamante 4 mm.

Characteristics:

Diamond drill, suitable for working on chipboard panels, M.D.F. with thin layers coatings or thin papers covered, elevate feeding speed, excellent finishing and good wooden-chip extraction due to the special geometry construction, low noisiness.

Diamond height 4 mm.

Punte fora e contorna per pantografo

Drills to perforate and blank for pantograph



| ØD | L | Ød | Z | Codice |
|----|----|----|------|--------------------|
| 20 | 20 | 20 | 8+1 | FP54.020.20.20.R/L |
| 20 | 25 | 20 | 10+1 | FP54.020.25.20.R/L |
| 20 | 30 | 20 | 12+1 | FP54.020.30.20.R/L |
| 20 | 35 | 20 | 14+1 | FP54.020.35.20.R/L |
| 20 | 40 | 20 | 16+1 | FP54.020.40.20.R/L |
| 20 | 45 | 20 | 18+1 | FP54.020.45.20.R/L |
| 22 | 20 | 20 | 8+1 | FP54.022.20.20.R/L |
| 22 | 25 | 20 | 10+1 | FP54.022.25.20.R/L |
| 22 | 30 | 20 | 12+1 | FP54.022.30.20.R/L |
| 22 | 35 | 20 | 14+1 | FP54.022.35.20.R/L |
| 22 | 40 | 20 | 16+1 | FP54.022.40.20.R/L |
| 22 | 45 | 20 | 18+1 | FP54.022.45.20.R/L |
| 22 | 50 | 20 | 20+1 | FP54.022.50.20.R/L |
| 22 | 55 | 20 | 22+1 | FP54.022.55.20.R/L |
| 25 | 20 | 25 | 8+1 | FP54.025.20.25.R/L |
| 25 | 25 | 25 | 10+1 | FP54.025.25.25.R/L |
| 25 | 30 | 25 | 12+1 | FP54.025.30.25.R/L |
| 25 | 35 | 25 | 14+1 | FP54.025.35.25.R/L |
| 25 | 40 | 25 | 16+1 | FP54.025.40.25.R/L |
| 25 | 45 | 25 | 18+1 | FP54.025.45.25.R/L |
| 25 | 50 | 25 | 20+1 | FP54.025.50.25.R/L |
| 25 | 55 | 25 | 22+1 | FP54.025.55.25.R/L |
| 25 | 60 | 25 | 24+1 | FP54.025.60.25.R/L |
| 25 | 65 | 25 | 26+1 | FP54.025.65.25.R/L |

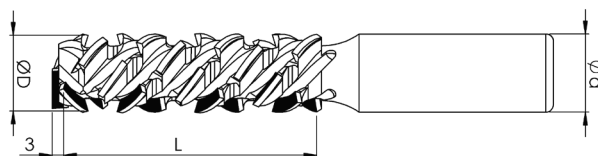

Caratteristiche :

Punta in diamante taglio assiale 54°, adatta per lavorazioni di pannelli truciolari, M.D.F. con rivestimenti di lamine o carte molto sottili, elevate velocità di avanzamento, eccellente finitura ed estrazione del truciolo grazie alla speciale geometria di costruzione, bassa rumorosità.

Altezza diamante 4 mm.

Characteristics:

Diamond drill, suitable for working on chipboard panels, M.D.F. with thin layers coatings or thin papers covered, elevate feeding speed, excellent finishing and good wooden-chip extraction due to the special geometry construction, low noisiness.

Diamond height 4 mm.

Punte fora e contorna per pantografo

Drills to perforate and blank for pantograph



| ØD | L | Ød | Z | Codice |
|----|----|----|---|---------------------------|
| 6 | 11 | 6 | 1 | FH10.006.11.01.R/L |
| 8 | 11 | 8 | 1 | FH10.008.11.01.R/L |
| 8 | 15 | 8 | 1 | FH10.008.15.01.R/L |
| 8 | 20 | 8 | 1 | FH10.008.20.01.R/L |
| 8 | 11 | 8 | 2 | FH10.008.11.02.R/L |
| 8 | 15 | 8 | 2 | FH10.008.15.02.R/L |
| 8 | 20 | 8 | 2 | FH10.008.20.02.R/L |
| 10 | 11 | 10 | 1 | FH10.010.11.01.R/L |
| 10 | 15 | 10 | 1 | FH10.010.15.01.R/L |
| 10 | 20 | 10 | 1 | FH10.010.20.01.R/L |
| 10 | 25 | 10 | 1 | FH10.010.25.01.R/L |
| 10 | 30 | 10 | 1 | FH10.010.30.01.R/L |
| 10 | 11 | 10 | 2 | FH10.010.11.02.R/L |
| 10 | 15 | 10 | 2 | FH10.010.15.02.R/L |
| 10 | 20 | 10 | 2 | FH10.010.20.02.R/L |
| 10 | 25 | 10 | 2 | FH10.010.25.02.R/L |
| 10 | 30 | 10 | 2 | FH10.010.30.02.R/L |
| 12 | 11 | 12 | 1 | FH10.012.11.01.R/L |
| 12 | 15 | 12 | 1 | FH10.012.15.01.R/L |
| 12 | 20 | 12 | 1 | FH10.012.20.01.R/L |
| 12 | 25 | 12 | 1 | FH10.012.25.01.R/L |
| 12 | 30 | 12 | 1 | FH10.012.30.01.R/L |
| 12 | 11 | 12 | 2 | FH10.012.11.02.R/L |
| 12 | 15 | 12 | 2 | FH10.012.15.02.R/L |
| 12 | 20 | 12 | 2 | FH10.012.20.02.R/L |
| 12 | 25 | 12 | 2 | FH10.012.25.02.R/L |
| 12 | 30 | 12 | 2 | FH10.012.30.02.R/L |

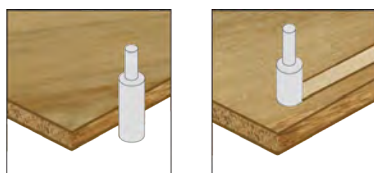

Caratteristiche :

Punta di piccolo diametro per pantografo per eseguire fori e scanalature all'interno dei pannelli, su truciolare rivestito e non, MDF, laminati in genere.

Corpo in HM integrale.

Characteristics:

Drill of small diameter for pantograph for making inside the panels, on coated chipboard and not, MDF, laminated in general.

Full Carbide body.