

Punte fora e contorna per pantografo

Drills to perforate and blank for pantograph

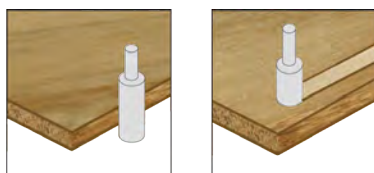

| ØD | L | Ød | Z | Codice |
|----|----|----|---|---------------------------|
| 6 | 11 | 6 | 1 | FH10.006.11.01.R/L |
| 8 | 11 | 8 | 1 | FH10.008.11.01.R/L |
| 8 | 15 | 8 | 1 | FH10.008.15.01.R/L |
| 8 | 20 | 8 | 1 | FH10.008.20.01.R/L |
| 8 | 11 | 8 | 2 | FH10.008.11.02.R/L |
| 8 | 15 | 8 | 2 | FH10.008.15.02.R/L |
| 8 | 20 | 8 | 2 | FH10.008.20.02.R/L |
| 10 | 11 | 10 | 1 | FH10.010.11.01.R/L |
| 10 | 15 | 10 | 1 | FH10.010.15.01.R/L |
| 10 | 20 | 10 | 1 | FH10.010.20.01.R/L |
| 10 | 25 | 10 | 1 | FH10.010.25.01.R/L |
| 10 | 30 | 10 | 1 | FH10.010.30.01.R/L |
| 10 | 11 | 10 | 2 | FH10.010.11.02.R/L |
| 10 | 15 | 10 | 2 | FH10.010.15.02.R/L |
| 10 | 20 | 10 | 2 | FH10.010.20.02.R/L |
| 10 | 25 | 10 | 2 | FH10.010.25.02.R/L |
| 10 | 30 | 10 | 2 | FH10.010.30.02.R/L |
| 12 | 11 | 12 | 1 | FH10.012.11.01.R/L |
| 12 | 15 | 12 | 1 | FH10.012.15.01.R/L |
| 12 | 20 | 12 | 1 | FH10.012.20.01.R/L |
| 12 | 25 | 12 | 1 | FH10.012.25.01.R/L |
| 12 | 30 | 12 | 1 | FH10.012.30.01.R/L |
| 12 | 11 | 12 | 2 | FH10.012.11.02.R/L |
| 12 | 15 | 12 | 2 | FH10.012.15.02.R/L |
| 12 | 20 | 12 | 2 | FH10.012.20.02.R/L |
| 12 | 25 | 12 | 2 | FH10.012.25.02.R/L |
| 12 | 30 | 12 | 2 | FH10.012.30.02.R/L |



Caratteristiche :

Punta di piccolo diametro per pantografo per eseguire fori e scanalature all'interno dei pannelli, su truciolare rivestito e non, MDF, laminati in genere.

Corpo in HM integrale.

Characteristics:

Drill of small diameter for pantograph for making inside the panels, on coated chipboard and not, MDF, laminated in general.

Full Carbide body.